

Robert Irvin
now
Leah Hill

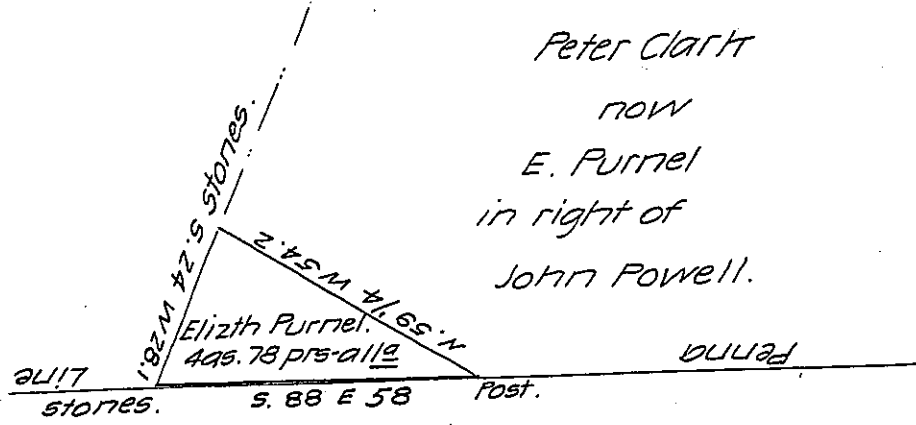

State Line Md.

Situated in Bethel Township Fulton Co. Penna Containing four acres and seventy eight perches and the usual allowances of 6 per cent for roads &c. Surveyed the 22d day of January A.D. 1866 by Geo. Holly Esq. in pursuance of a Warrant granted to Peter Clark bearing date the 1st of January A.D. 1866 and transferred by him to Elizabeth Purmel the 12th of May 1866. Carefully examined and approved ~~the~~ by me the 4th of december A.D. 1866.

Wm. P. Gordon Co. Sr.

To Jacob M. Campbell Esq
Surveyor General.

IN TESTIMONY that the above is a copy of the original remaining on file in the Department of Internal Affairs of Pennsylvania, made conformably to an Act of Assembly approved the 16th day of February, 1833, I have hereunto set my Hand and caused the Seal of said Department to be affixed at Harrisburg, this twenty-eighth day of October 1907

Henry Houck
Secretary of Internal Affairs.